



WORKBENCH WITH 3 DRAWERS AND REAR UPSTAND



Length	540, 740
Width	600, 700, 800

Manufactured in stainless steel AISI 304. Working top in AISI 304 sheet, 1.20mm thick, with inner plywood reinforcement and stainless steel lower cover. Rounded (R=10mm) front upper edge, as well as rounded (R=2mm) side and back edges. Optional rear stainless steel upstand H=100mm, welded and closed on the back, and with R=10mm rounded lower edge. With full-extraction drawers on stainless steel rails. On stainless steel telescopic feet, the rear ones advanced for rounded floor.

SKU: N/A



		W		
		600	700	800
L	Cod.	Cod.	Cod.	Cod.

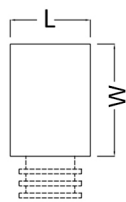

540	T15301001	T15302001	T15303001
740	T15301002	T15302002	T15303002

W = Width / Profondità / Breite / Profondeur.
L = Length / Larghezza / Länge / Longueur.