



## WRITING STAND WITH 1 HINGED DOOR AND 2 DRAWERS ON CASTORS



<b>Length</b>	550
<b>Width</b>	500, 600, 700
<b>Hinged door opening</b>	left, right

Entirely manufactured in stainless steel AISI 304. Hinged door mounted on removable hinges. With 2 drawers mounted on stainless steel rails. Inclined writing top with front bended edge to prevent paper drop. Frontal handle in round pipe. On 2 swivels and 2 braked anti-trace castors, diam. 125mm, and with stainless steel frame.

---

**SKU:** N/A



L	W		
	500	600	700
	Cod.	Cod.	Cod.

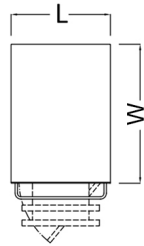

550	T11601001	T11602001	T11603001
-----	-----------	-----------	-----------

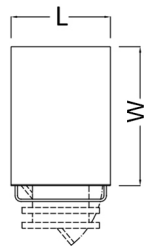

550	T11701001	T11702001	T11703001
-----	-----------	-----------	-----------

**W** = Width / Profondità / Breite / Profondeur.  
**L** = Length / Larghezza / Länge / Longueur.